

## Wall: Timber construction *Airtight on the inside*

### Wall joint - timber construction outside corner



- Affix Corvum to wall with folded edge flush against outside edge
- Add about 3 cm at each end and cut off



- Remove backing strip
- Unfold



- Cut into the corner from the inside out, approximately bisecting the angle
- **Start cut just short of corner!**

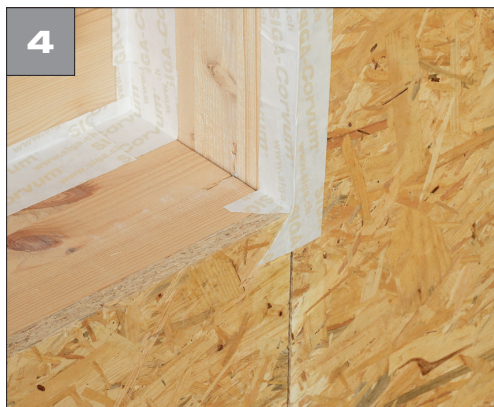

- Fold around outside corner
- Press on

## Wall: Timber construction *Airtight on the inside*

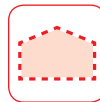

- Repeat on each side



- Fit a short piece of Corvum into corner
- Remove the backing strip
- Press on
- Repeat on each side



### How it should look:

- Outside corner is permanently airtightly sealed with Corvum 30/30



**Corvum® 30/30**

P. 116



## Wall: Timber construction

### *Airtight on the inside*

#### Joining window to timber wall construction



- Cut off a short piece, unfold
- Make a 12 mm cut in the centre of one side



- Fold over at a 90° angle
- Bond together
- Make a corner crease



- Remove backing strip



- Press into inside corner
- Affix 12 mm side of Corvum to window frame
- Repeat in each inside corner



## Wall: Timber construction

### *Airtight on the inside*



- Then connect the inside corners:
- Affix 12 mm side of Corvum to window frame
- Measure and cut to the correct length



- Remove backing strip
- Unfold
- Press on
- Repeat on each side



#### **How it should look:**

- Recessed window frame airtightly bonded with Corvum 12/48
- Corvum is invisible behind cladding



**Corvum® 12/48**

P. 117

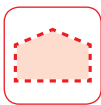

## Wall: Timber construction

### *Airtight on the inside*

#### Joining window to timber wall construction



- Bond to windowsill joint profile **at the bottom**
- Projecting by joint width plus approx. 6 cm on both sides
- Press on firmly

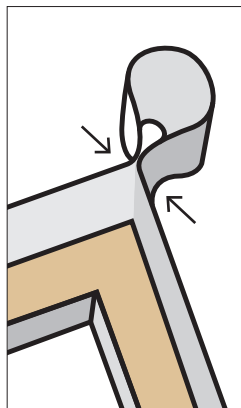

- Bond laterally to the frame
- Press on firmly

#### **Top corners:**

- Form a loop: 1.5 x joint width
- Bond or press together firmly
- Repeat on the other side



- Install the window

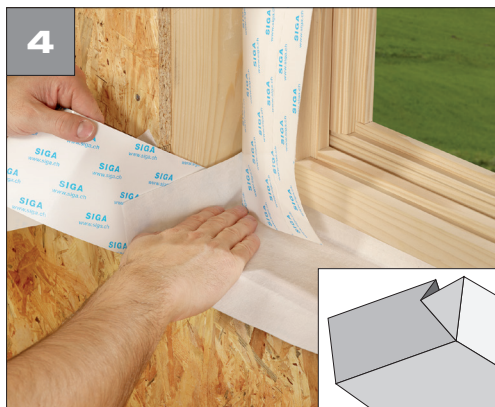

- Form trough

## Wall: Timber construction *Airtight on the inside*

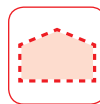

- Cut into the corners
- Remove backing strip and press on firmly



- Repeat on each side



### How it should look:

- Window frame joined airtight to timber wall construction



**Fentrim® IS 20**

P. 132